

SMART PROJECTOR

User Manual

First of all thank you for using our smart projector! Please read this manual carefully before using so it will help you to quickly be familiar with this product. Please be informed that product performance and functionality can be changed without prenotice. If you find out any error with this manual, please call the our customer service.

I/Os

- | | | | |
|------------|-----------|----------|-----------|
| 1.UP | 2.OK | 3.LEFT | 4.RIGHT |
| 5.DEFT | 6.MENU | 7.RETURN | 8.HD-IN |
| 9.DC-IN | 10.UB1 | 11.UB2 | 12.ON/OFF |
| 13.FAN | 14.ENGINE | 15.FOCUS | 16.RESET |
| 17.TF CARD | | | |



1

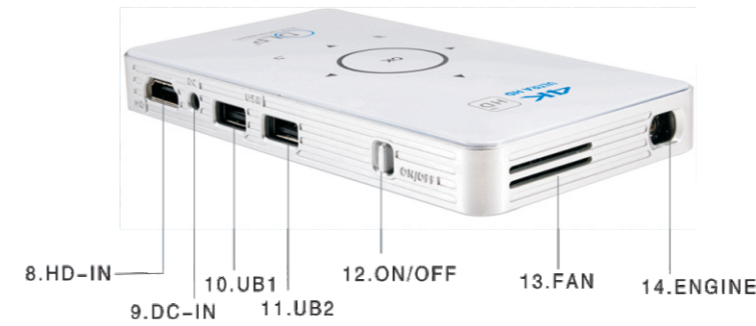

2

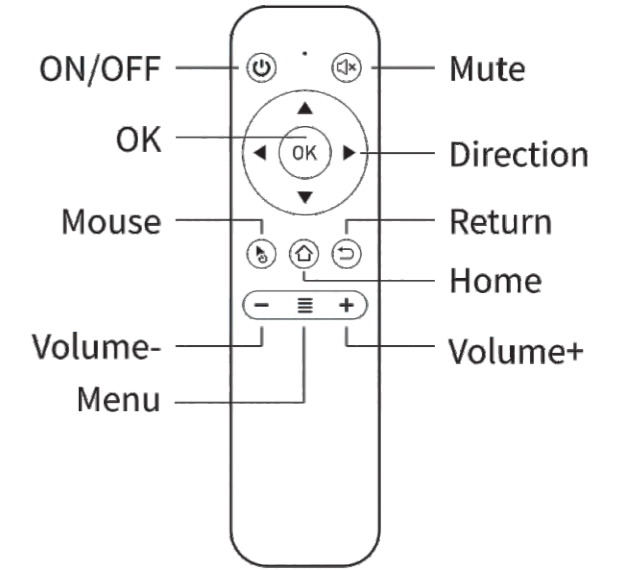

Projector Power on/off

- Power on: Switch down the [ON/OFF] on the right side of the projector and wait for the screen to display.
- Power off: Switch down the [ON/OFF] on the right side of the projector, the interface of shutdown will pop up, click "OK" to shut down, after the projector stops running, please switch the [ON/OFF] up to the top, otherwise the battery will still be in a power-consuming state.

3

Home



- Screenshot
- Home
- Volume-
- Shutdown
- return
- Background
- Volume+
- Hide

4

Settings

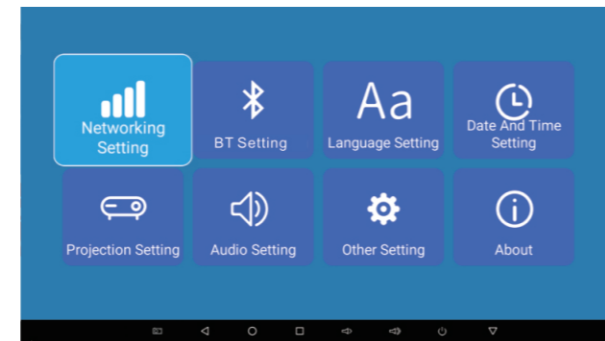

WI-FI Setting

Enter "Settings" → "Networking Setting" → "WI-FI Setting", click the switch to "ON" state, select the network you want to connect to, enter the password, and click "Link".

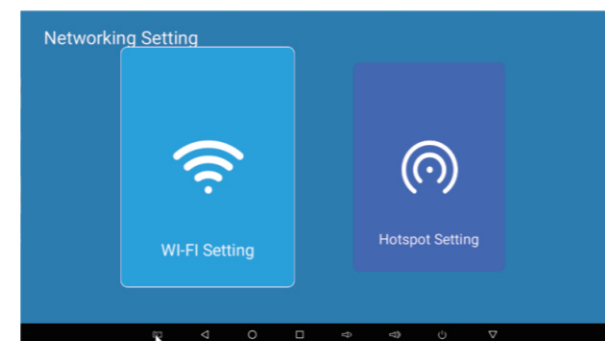

5



Hotspot Setting

Enter "Settings" → "Networking Setting" → "Hotspot Setting", click the switch to "ON" state, you can set the parameters of your own, click "OK", and then the projector's hotspot can be searched by other devices to share the network.

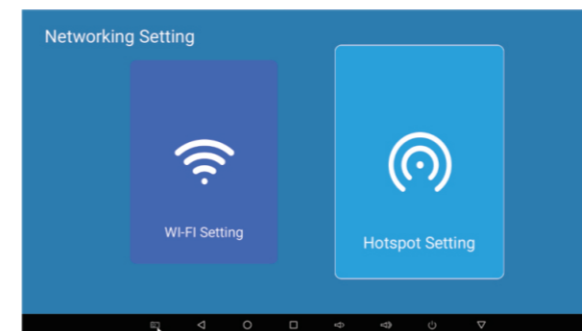

6



BT Setting

Enter "Settings" → "BT Setting", click to the "ON" state, search for the device which want to connect the device, pairing.

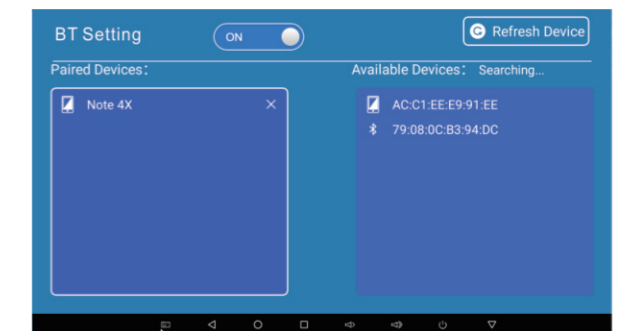

7

App Center

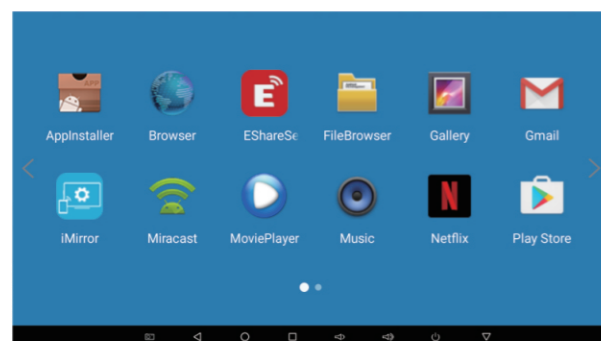

Screen share

Method one: need to download the APP

(recommended for iPhone/iPad/Windows/Android)

- The phone and the projector are connected to the same network, or in the absence of a network, the phone is connected to the hotspot of the projector. (Details of the hotspot setting method, see 10)
- Enter the APP "EShareServer" on the projector and follow the steps of the screen.

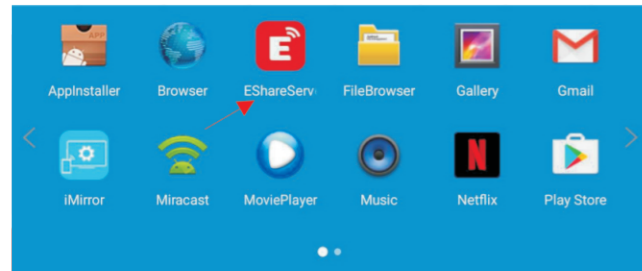

8

Method two: no need to download the APP

① Miracast(for Android system):

- The phone and the projector are connected to the same network.
- Enter the APP "Miracast" on the projector.
- Enter "Settings" → "More" → "Wireless Display" on the phone, and click the name of the device to match.

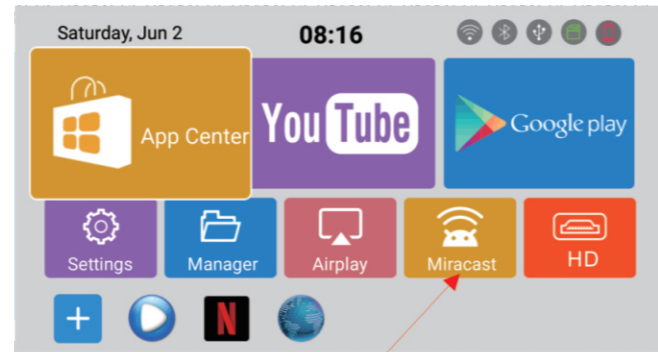

Android mobile-phone

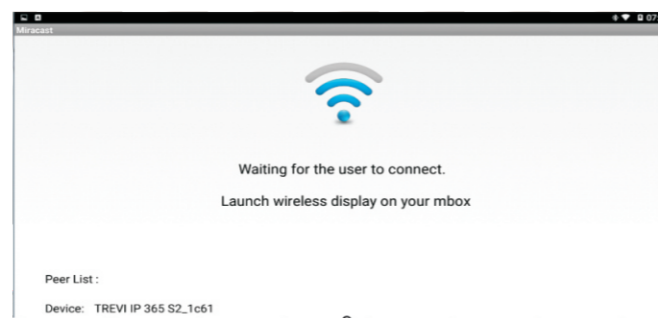

9

Android Smart phone screen sharing APP operation(HUAWEI, SAMSUNG)

1. HUAWEI smart phone

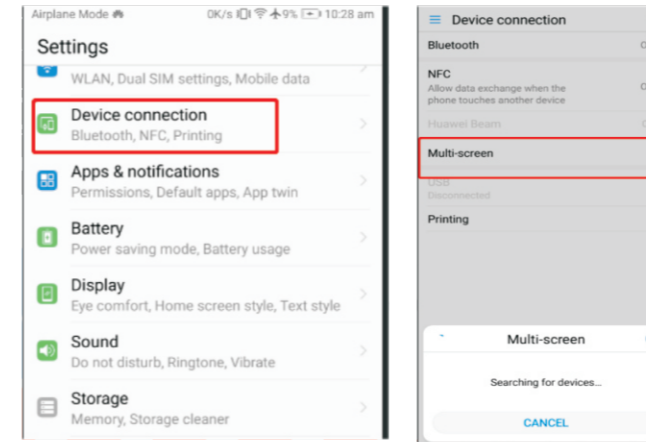

2. SAMSUNG smart phone

Check arrow pointed drop-down menu, select: Smart View

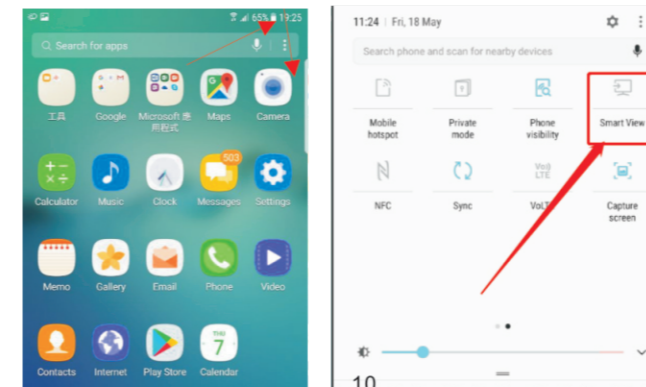

10

ios syseem screen share

② iMirror(for iOS system):

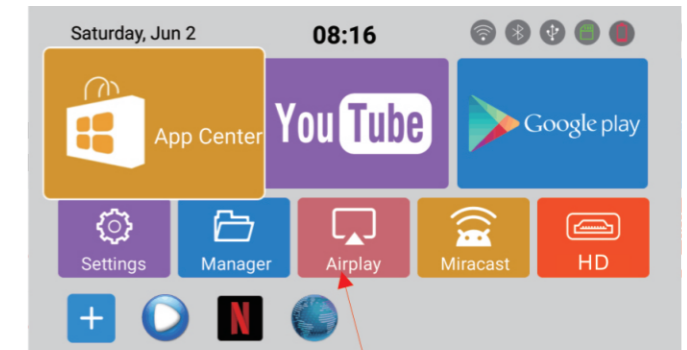

- The phone and the projector are connected to the same network, or in the absence of a network, the phone is connected to the hotspot of the projector. (Details of the hotspot setting method, see 10)
- Enter the APP "iMirror" on the projector .
- Open the "Screen Mirroring" on the iPhone/iPad, and click the name of the device to match.



ISO System

11

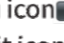
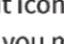
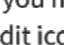
File Browser

- Read: Insert the U disk/TF card, enter the "File Browser".
- Edit: Select the menu icon , tick the file you want to operate , deselect the menu icon , select the options you want to operate in the edit icon directory .
- If "Cut" or "Copy" is selected, you need to first select the directory, and then click the edit icon  to select "Paste".

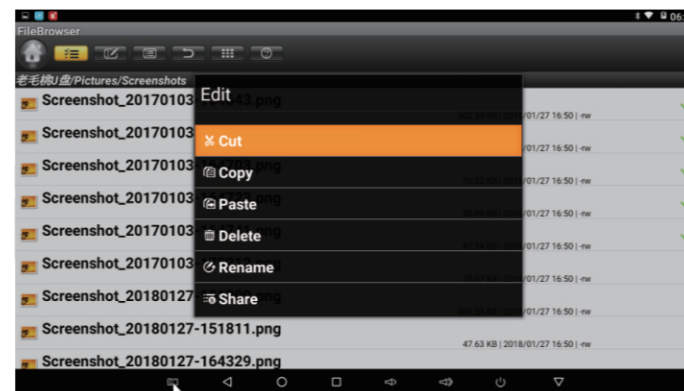

13

APP install/uninstall

- APP install: If the APK Downloaded, enter the "App Center" → "AppInstaller", find the location of the APK , click and install it; If the APK is not downloaded , you can download and install it in the "Google Play".

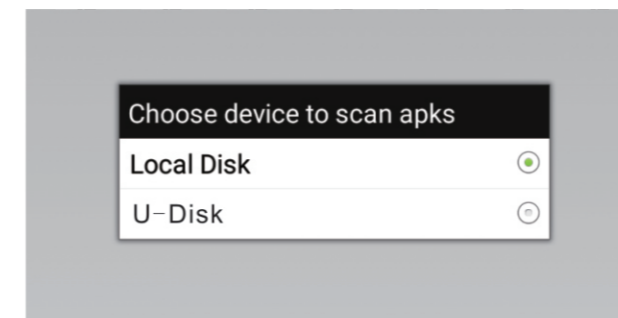

- APP uninstall: Enter "Settings" → "Other Setting" → "Apps", click the App that needs to be uninstalled.

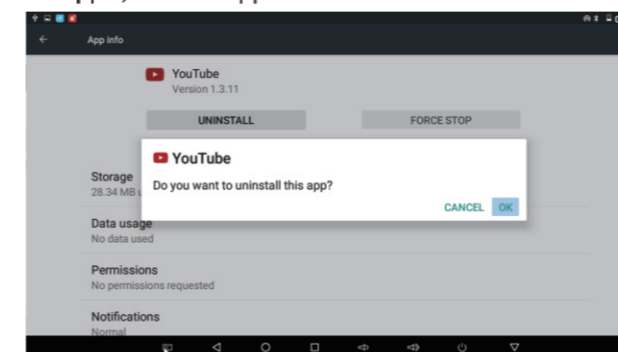

14

Factory data reset

Enter "Settings" → "Other Setting" → "Backup & reset" → "Factory data reset" → "RESET MBX".

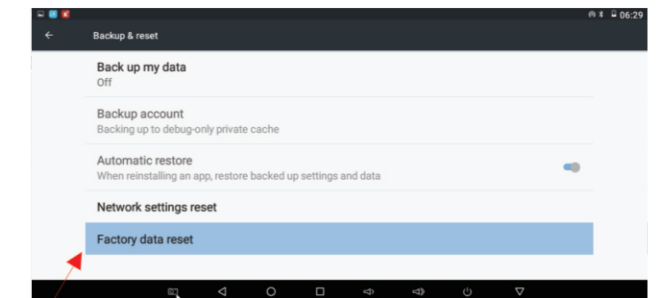

16. Notes

- Make sure to use a standard power adapter. Other adapters may cause serious damage to the projector.
- Please keep the lens clean, dirt or scratches will affect the projection effect.
- Before you clean the projector, disconnect the power supply, clean it with a clean cotton wool or soft cloth, and then wipe off the residual moisture with a dry cloth.
- Do not place or drop hard objects on the projector.
- Do not place the projector on your legs or any part of your body to prevent injury from the heat.
- Avoid using the projector during weather of high humidity or thunderstorms.

15

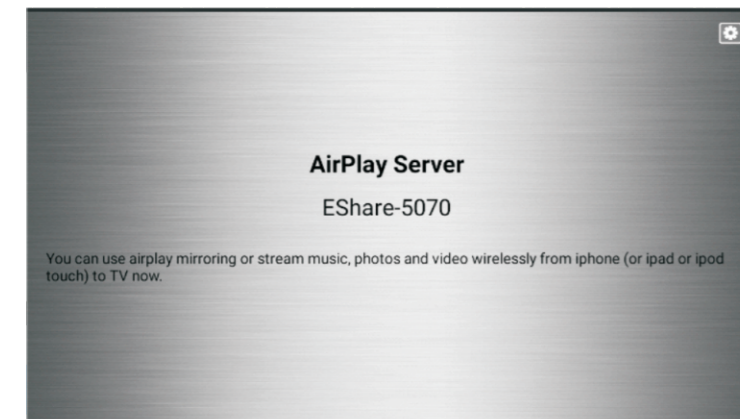

Apple mobile-phone

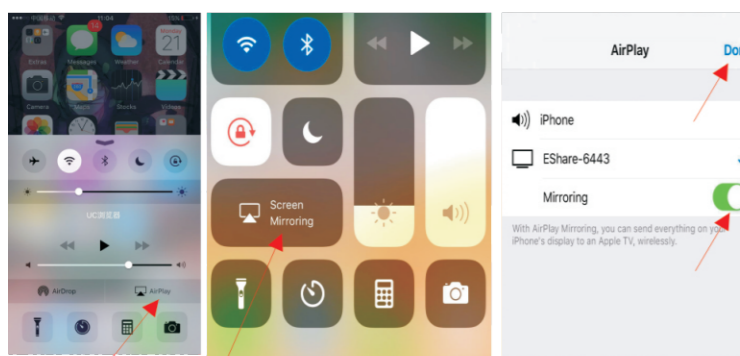

12